

TECHNOBOTIX :-D37R24C

:: BBOX TORQUE SERIES

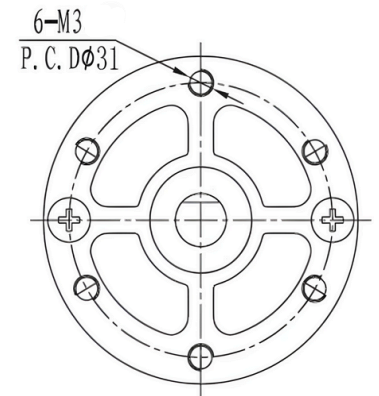

Dimension(mm)

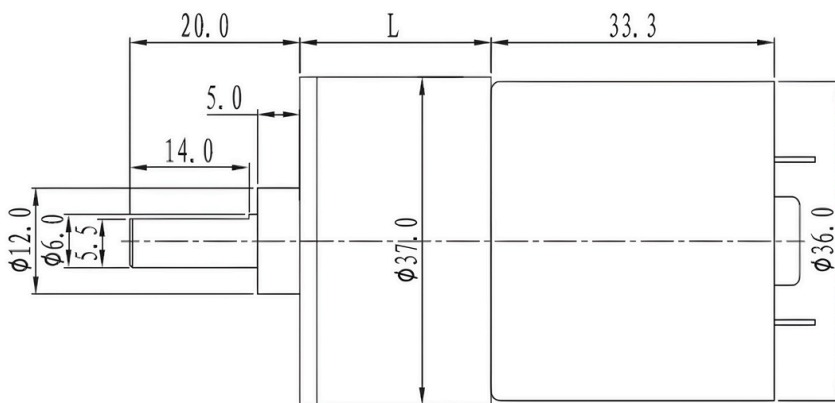

TECH SPEC

DETAIL

Operating Voltage (VDC)	6v - 12v
Nominal Voltage (V)	12
GB Reduction Ratio	24
Rated Base Motor RPM	6500
Motor No Load RPM	270
Gear Material	Metal
Rated Torque (Kgf.cm)	1.5kg.cm
Rated Power (W)	3.4W
Shaft Diameter (mm)	6 mm
Shaft length (mm)	14 mm
Gearbox Diameter (mm)	37 mm
Motor Diameter(mm)	36 mm
Total Length (mm)	77.8 mm
Weight (gm)	0.19kg
Gear box Width (L)	23 mm

